

# SLIDER24+

## IN-LINE SLIDING PATIO DOOR

### FRAMING

- dedicated multi-chamber sash and outer frame
- Part M compliant low threshold

### SEALS/GASKETS

- main profiles supplied with high-performance integral multifunctional seal/gasket and wool pile

### REINFORCING

- galvanised steel profiles optimised for strength and rigidity

### DOOR STYLES

- two, three and four pane door styles
- dedicated midrail for letterplates

### FABRICATION

- fully welded and mechanically joined frame
- mechanically joined midrail options
- mechanically joined low threshold

### GLAZING

- choice of two glazing bead styles
- glazing options from 4mm up to 36mm thickness

### ANCILLARIES

- frame extensions and cills
- lightweight and structural coupling members
- clip-fit frame trims
- PVC and aluminium interlock options

### HARDWARE

- multi (12) point locking
- Document Q and M compliant
- anti-lift device

### SECURITY

- Kitemarked approved to PAS 24 enhanced security standard

### THERMAL INSULATION

- Ud 0.98W/m<sup>2</sup>k
- DSER E to A++

### DESIGN

- market leading weather performance
- internally sliding sashes
- complements classical and contemporary architecture
- white colour RAL 9016
- many foil colour options available from stock
- Decoroc® colours and more foils on request

## SIZE LIMITATION AND PERFORMANCE CHARACTERISTICS

### SLIDER24+ PVC-U DOOR SYSTEM

DOOR TYPE	LENGTH (MM) - MAXIMUM	HEIGHT (MM) - MAXIMUM (INCLUDING CILL)	AIR PERMEABILITY CLASSIFICATION	WATER TIGHTNESS CLASSIFICATION	RESISTANCE TO WIND CLASSIFICATION	EXPOSURE CATEGORY AS GIVEN IN TABLE 1 OF BS 6375-1
-----------	--------------------------	--	------------------------------------	-----------------------------------	---	--

SASH DIMENSIONS FOR DOORS WITH APPROVED OUTER FRAME AND SASH PROFILES

2-PANE XO, OX TYPES	2700	2250	4	8A	B3	1200
3-PANE OXO, XOO, OOX TYPES	4050	2250	4	8A	B3	1200
4-PANE OXXO TYPES	5400	2250	4	8A	B3	1200
MAXIMUM LEAF SIZE	1350	2150	-	-	-	-

"o" denotes fixed panel "x" denotes sliding panel when viewed from the outside

# SLIDER24+

## IN-LINE SLIDING PATIO DOOR

deceuninck

nbsPlus

riba  
product  
selector

nbs  
BIM

### TECHNICAL AND SPECIFICATION SUPPORT

Specification Support forms an essential link between architects, specifiers and approved Deceuninck fabricators and installers. The team provide informed guidance on the use of products, samples, drawings and specifications with contact maintained throughout each stage of a contract to completion.

Deceuninck can offer a technical and design service for suitable schemes embracing:



- product selection and application
- technical review to confirm compliance with Building Regulations
- advice on exposure conditions
- wind load calculations
- framing construction and design solutions
- generation of scheme drawings for tendering purposes
- technical specification
- window samples for client/authority approval

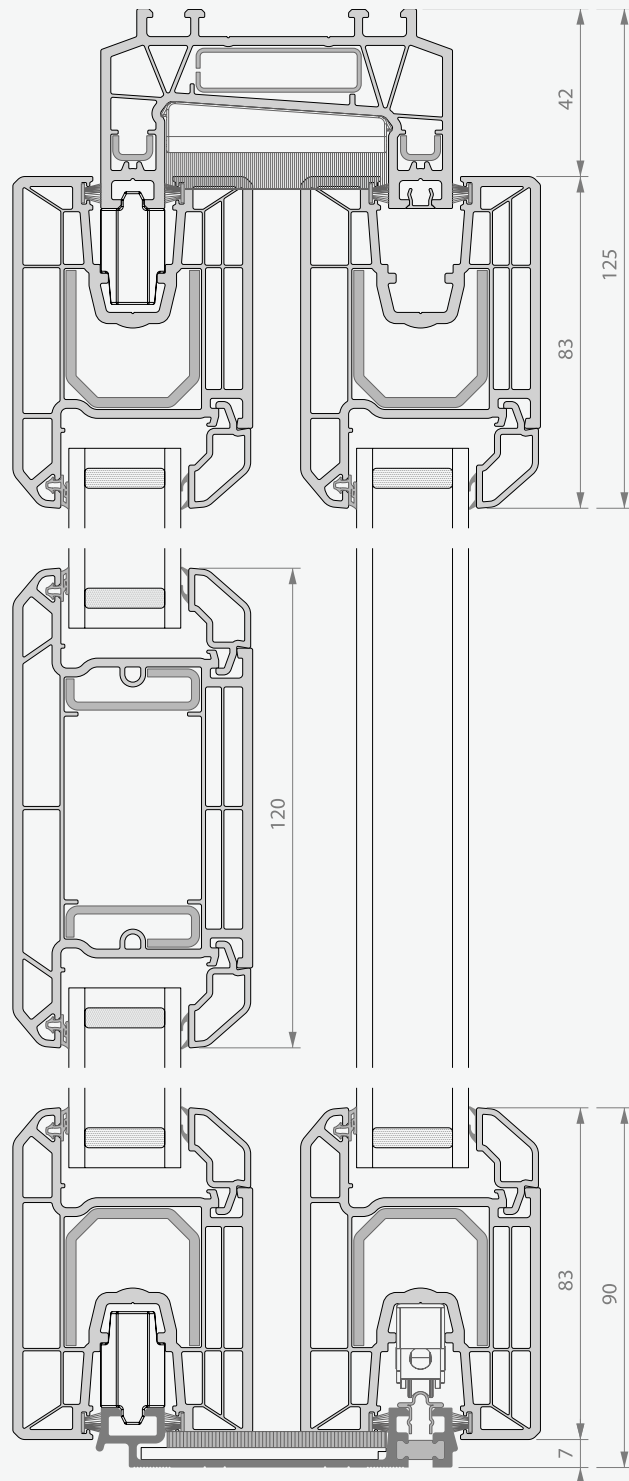

deceuninck

**SLIDER24+**  
IN-LINE SLIDING PATIO DOOR



# SLIDER24+

## IN-LINE SLIDING PATIO DOOR

deceuninck

### MAXIMUM SASH DIMENSIONS

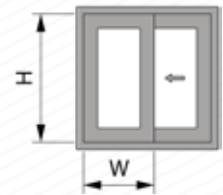
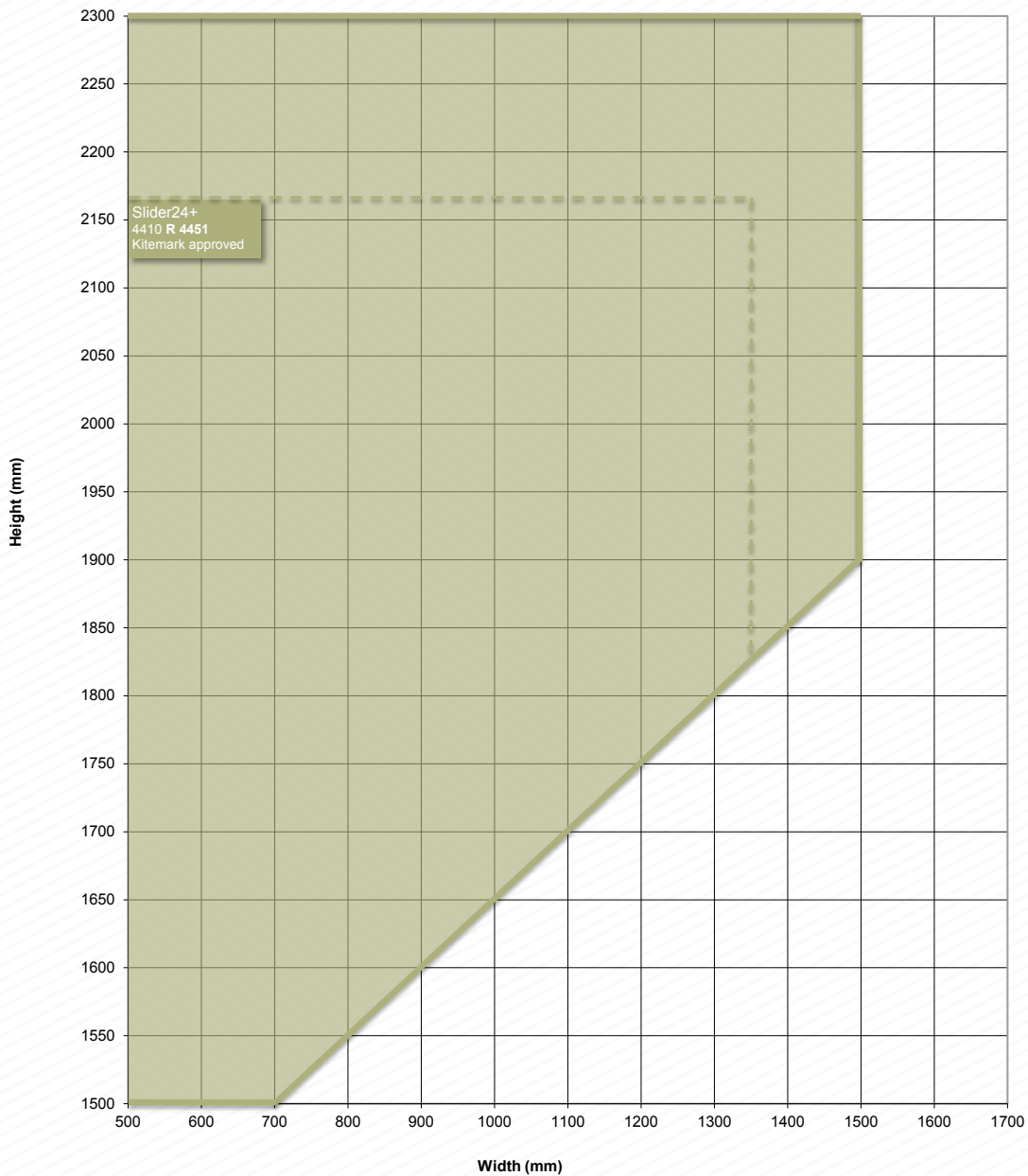

**SLIDER24+**  
PRODUCT RANGE

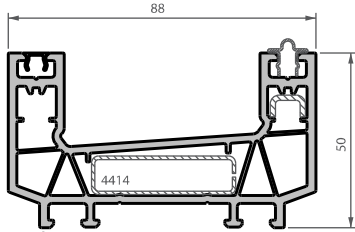

4400 frame

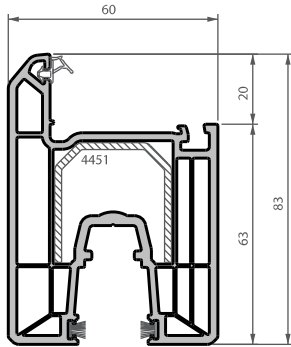

4410 sash

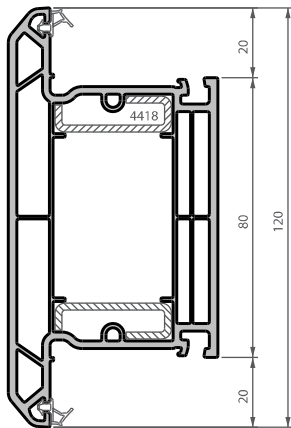

4435 mid-rail

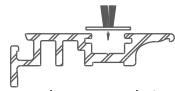

4453 aluminium interlock



3429 interlock wool pile

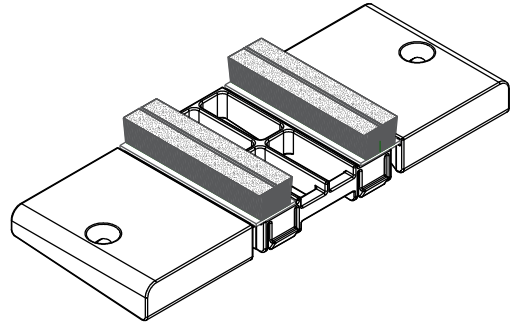

4426 brush block set

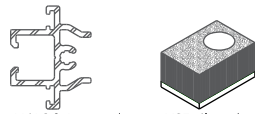

4461 3 & 4 pane adaptor 4427 pile end cap for 4461



4422 interlock cover trim

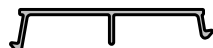

4416 bottom frame infill

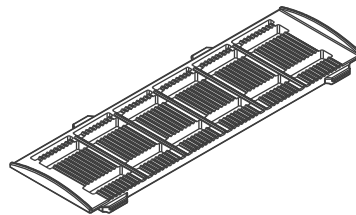

4463 glazing bridge

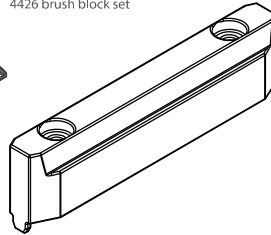

4417 fixed pane support packer

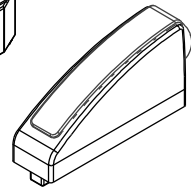

4466 bump stop



4456 cover trim

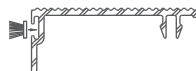

4460 threshold cover trim



4402 steel track



3403 frame infill trim

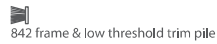

842 frame & low threshold trim pile

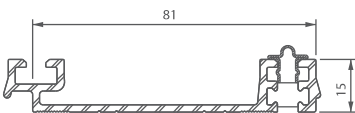

4462 aluminium low threshold

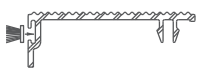

4464 low threshold cover trim

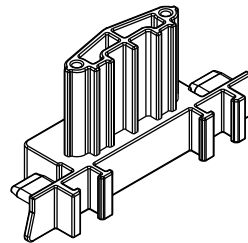

4429 low threshold end cap

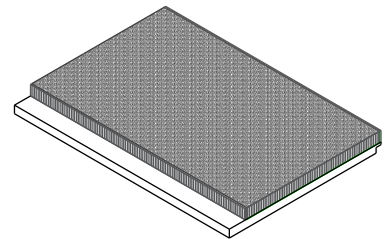

4428 low threshold brush block

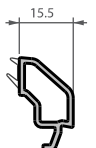

4432 (28mm)

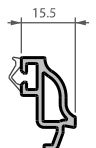

3132 (28mm)

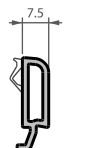

3038 (36mm)



4413 for 4400

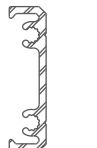

3408 for 4400

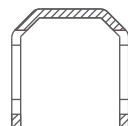

4452 for 4410 (prepped)



4470 letter plate kit

SLIDER24+  
PRODUCT RANGE

